

Huntsman

ALUMNI MAGAZINE



Special Issue



Huntsman

ALUMNI MAGAZINE

SPRING 2016

PUBLISHER

Douglas D. Anderson, Dean and Professor

MANAGING EDITOR

Dave Patel, Associate Dean, Student & External Affairs

ART DIRECTOR

Hilary Frisby

COPY EDITORS

Tonya Davis
Kim Larson

CONTRIBUTING WRITERS

Dave Patel

CONTRIBUTING PHOTOGRAPHERS

Ron Adair
Donna Barry
Emily Beus
Hilary Frisby
Casey McFarland
Kyle Spackman
Sylvia Weston

NATIONAL ADVISORY BOARD

Gary Anderson	Jay Francis	Roger McOmber
Timothy Barney	Lynnette Hansen	Steve Milovich
Gary Black	Larry Hendricks	Brady Murray
Brian Broadbent	David Hickox	R. Pepper Murray
William Bullen, Jr.	Peter Huntsman	Stephen Neeleman
David Colling	Brad Jackman	Paul Parkinson
Boyd Craig	David Jenkins	Duane Shaw
Scott Davis	Richard King	David Stowell
Blake Dursteler	Ron Labrum	Nadir Tekarli
Mark Erickson (Chair)	Kurt Larsen	
Theresa Foxley	Crystal Maggelet	

Send comments and inquiries to:
huntsman.editor@usu.edu.

Huntsman Alumni Magazine is published twice a year by the
Jon M. Huntsman School of Business at Utah State University in Logan, Utah.
This issue was printed at Hudson Printing in Salt Lake City, Utah.

Copyright 2016 by Utah State University. All rights reserved.

huntsman.usu.edu/alumnispring2016

◀ Huntsman student leaders cut the official ribbon. Photo by Sylvia Weston

dean's message



When the George S. Eccles Business Building opened on May 8, 1970, it was the tallest structure between Ogden, Utah, and Boise, Idaho. That venerable building has served thousands of students and remains an iconic landmark for generations of Aggies.

On March 16, 2016, we celebrated the opening of Jon M. Huntsman Hall to accommodate the growing needs of the business school and of the university. Now fully connected and integrated with the Eccles Business Building, Huntsman Hall is designed and built, first and foremost, for our students. The 21 classrooms and 21 team study rooms provide students with an unparalleled learning environment, one that I am certain is the equal of any college building in the world.

As I walk through Huntsman Hall, I can feel the transformative impact this beautiful facility will have on generations of students. The thoughtful design, incorporating light and the incomparable beauty of Cache Valley into virtually every corner, creates an

inviting and welcoming space.

This beautiful building would not be possible without support from so many of you. The namesake of our business school, Jon M. Huntsman, Sr., provided the lead gift, and he and his wife Karen and their family lent

their time and energy to making our dream a reality. Jon and Karen have chosen to devote their talents, energy, and considerable fortune to saving lives and to prepare the next generation to contribute to our

“Huntsman Hall is designed and built, first and foremost, for our students.”

society and culture. It is only fitting that this lovely edifice should be named the Jon M. Huntsman Hall.

Their early support was supplemented by our amazing alumni and friends. Together, almost 70 percent of the \$50 million total project came from private support. The State of Utah provided approximately \$15 million. We could not have built a facility of this quality without you.

In this special issue of the Huntsman Alumni Magazine, we want to share some moments from the grand opening of Huntsman Hall, and to thank all those who made our vision a reality. You can view the video of the ceremonial opening at this link: https://huntsman.usu.edu/huntsmanhall/grand_opening

My deepest appreciation goes to all of you. Thank you so much. Please come see Huntsman Hall when you next visit our beautiful campus in Logan. It is your building, too!

PHOTO BY RON ADAIR

contents



special issue

8 DARE MIGHTY THINGS
Jon M. Huntsman Hall Becomes a Reality

6 My Huntsman Experience

7 My Favorite Professor

30 Contributions

34 How I'm Building Huntsman

On the cover: Jon M. Huntsman and Utah Governor Gary Herbert celebrate after cutting the ribbon to open Jon M. Huntsman Hall. Photo by Casey McFarland.

Back cover photo by Sylvia Weston.



MY HUNTSMAN EXPERIENCE

BY PRESTON NAEGLER,
ACCOUNTING, FINANCE & ECONOMICS, '16;
SCHOLAR OF THE YEAR

My experience in the Huntsman School of Business has been transformative. I came to college thinking I would pick a major, finish school quickly, and start my career. I never expected to discover the entire world at my fingertips in Logan, but the Huntsman School provides its students with countless opportunities to do just that. I am extremely grateful to have been involved in numerous service projects, traveled throughout the world, and interacted with business and government leaders. These opportunities have helped me to recognize the positive impact that I can make on the world. As Jon Huntsman said, "Wealth isn't always measured in dollar signs. We each have time, talent and creativity, all of which can be powerful forces for positive change." I remember sitting in a humble home in Trujillo, Peru, asking a hopeful entrepreneur about his business plans and thinking, "THIS is what business is about; helping people." I will never forget the experiences like this that have changed me as a person and expanded my vision to truly "Dare Mighty Things."

The friendships I developed with my fellow Huntsman students are priceless. I interacted with some of the brightest and most humble students, each of whom challenged me to study harder and serve more in the community. As I look to graduation, I am inspired to look beyond myself for opportunities to be a service-oriented leader in life after USU.

My professors in the Huntsman School had a profound effect on how I analytically evaluate the world around me. During the Huntsman Scholar semester, Professors Shannon Peterson and John Ferguson challenged me to question all of my assumptions. One assumption that I questioned was the idea that businesses are only responsible for maximizing profit for shareholders. Upon further investigation, I quickly realized that this is not a "one size fits all" solution and that businesses have many other stakeholders that are impacted by their decisions. This challenge humbled me and made me realize how much I did not know. I can directly attribute my desire to be a lifelong learner to that experience.

My experience in the Huntsman School of Business has been much more than I could have ever hoped for. I am grateful for everything that the school has done for me, and I am excited for the opportunity to help current and future students have a similar experience.

PHOTO BY SYLVIA WESTON



my favorite professors

BY TREVOR SEAN OLSEN, FINANCE, '16
USU STUDENT BODY PRESIDENT

The Jon M Huntsman School of Business has given me the opportunity to rub shoulders with incredible professors, mentors, and friends. As I consider my time at the Huntsman School, there are so many professors I would like to thank, like Craig Petersen, Paul Fjeldsted, Ronda Callister, Vijay Kannan, Frank Shuman, and Strat Roper. There are two who really stand out as having made a huge impact on my education and my life.

John Ferguson taught my Business and Society course and my International Business Law course. Through both of those courses I learned a lot about myself and my personal beliefs and morals. He facilitated discussions that helped me learn to be open-minded to others' points-of-view. This gave me the opportunity to really decide what I think and how I would deal with difficult, ethical situations. He shaped the way I think, the way I solve problems, and the way I lead. Professor Ferguson shaped my ability to think critically more than any one person in my life. Beyond that, I always felt like he cared, not just about my success in the classroom,

but outside as well. He reached out to help while I was in his class and he has helped me many times since. Also, he convinced me out of law school without knowing it, which I think he would be proud of.

When I wasn't satisfied with the major I was in, I ended up in Professor Ben Blau's International Finance Class. I would have never guessed that I enjoy finance, but I do. At the beginning of every class he would pull up news articles that related to things we were learning and was able to explain to us, using current examples, how it applied in the real world. It got me really engaged and excited about finance and to this day I still get excited about finance. If it wasn't for Professor Blau, I would still be a lost college student wanting something more fulfilling.

I'm grateful for my time in the Huntsman School, and especially for the opportunity I have had to learn from the intelligent, humble, and caring faculty. My education and my life has been greatly enriched because of them.

PHOTO BY HILARY FRIBBY



DARE MIGHTY THINGS

Jon M. Huntsman Hall
Becomes a Reality

On March 16, 2016, we opened the doors of the Jon M. Huntsman Hall on the campus of Utah State University. Utah Governor Gary Herbert, members of the Huntsman family, dignitaries from the business and government communities, students, faculty, staff, alumni, and friends joined Utah State University President Stan Albrecht and Huntsman School Dean Douglas Anderson in a dedication and ribbon cutting ceremony. “This day is a significant step in our journey to create a world-class business education program,” stated Dean Anderson. “There is not a better building on any campus in the country. Our students will absolutely love studying here.”

Grand opening events included a dedication attended by business, government, and civic leaders, two ribbon cutting ceremonies, and an open

house. The American Festival Chorus, led by Dr. Craig Jessop, dean of the Caine College of the Arts at Utah State University, sang “Bless this House,” and “America the Beautiful.” Elder M. Russell Ballard of the Church of Jesus Christ of Latter-day Saints offered the dedicatory prayer.

Planning for the facility began over five years ago with a groundbreaking in the Fall of 2013. Contributions from alumni and friends funded nearly 70 percent of the total project cost of \$50 million. Alongside classrooms and student space, the building also houses the Jeffrey Clark Center for Entrepreneurship and the Partners in Business Program.

“I see a gathering of people here who love education, who love Utah State University, and love the State of Utah.”

— Governor Gary Herbert



“We’ve come here today to honor and recognize the Huntsman family and to celebrate the impact that they’re having on our students and on our university. What Jon and Karen and their family have done and are doing for us reflects the great passion that they have for our students. It’s also a manifestation of the shared passion and commitment that we have with them and with all of you to truly become one of the great undergraduate business schools in this great country.”

— President Stan Albrecht



PHOTOS BY DONNA BARRY, EMILY BEUS, CASEY MCFARLAND, SYLVIA WESTON





The 125,000 sq. ft. building, integrated with the existing George S. Eccles Business Building, provides much needed physical space for increasing enrollment, and signals the forward movement of the Huntsman School. Huntsman Hall is emblematic of our vision and values and promotes interaction through its very design. It is a place for people to be involved with others, for active learning, for interaction, collaboration, for teamwork. It is a space that promotes community.

An extensive assessment in 2011 included input from faculty, staff, students, and alumni, and resulted in a collaborative decision into our current and future needs. This assessment, and the programmatic study that followed, gave rise to plan for a building created first and foremost for our students. The 21 classrooms and 21 study rooms in Huntsman Hall provide students with an incredible learning environment, and combined with the various common areas throughout the building, as well as a café and outdoor spaces, gives the entire Huntsman School community of students, faculty, staff, alumni, and friends a singular space to gather and interact.

"I hope they teach that honesty, and integrity, and your word is your bond. Nothing else is going to be as important as teaching that to these students."

— Karen H. Huntsman



PHOTOS BY EMILY BEUS

“This exquisite new facility represents the very best of both the human spirit and individual integrity.”

— Jon M. Huntsman, Sr.

The completion of Huntsman Hall would not be possible without support from university leadership, especially from USU President Stan Albrecht, the Huntsman School National Advisory Board, faculty, staff, students, alumni, and friends.

The namesake of our business school, Jon M. Huntsman, Sr., provided the lead gift, which was then supplemented by our incredible alumni and friends. These early investors enabled us to bring our plans to reality.

This private support was complemented by funding from the State of Utah. This public-private partnership occurred despite difficult economic times and is a testament of a commitment to higher education and a recognition that the business school remains a tremendous engine of growth for our community.

PHOTOS BY EMILY BEUS, CASEY MCFARLAND, SYLVIA WESTON



We are grateful for the generous support of our alumni and friends in helping to build Huntsman Hall.

HUNTSMAN HALL DONORS

Donors above \$1,000,000

The Call Family Foundation
 Jeffrey D. & Bonnie Clark
 The George S. & Dolores Doré Eccles Foundation
 Kem & Carolyn Gardner
 Dell Loy & Lynnette Hansen
 Chairman Young Chul & Mrs. Mira Hong
 The Huntsman Foundation
 The Charles Koch Foundation
 The Larry H. & Gail Miller Family Foundation
 Duane & Marci Shaw
 The State of Utah

\$100,000 - \$999,999

Douglas & Kathy Anderson
 Brent & Bonnie Jean Beesley
 Howard S. Clark
 Charlie & Trina Denson
 Mark & Jennifer Erickson
 The Ernst & Young Foundation
 Mark K. & Wendi P. Holland
 Ron K. & Sherrie A. Labrum Trust
 Kurt & Dawn Larsen
 Dr. Stephen & Christine Neeleman
 Dr. Ann Rice
 Sorenson Legacy Foundation
 The O.C. Tanner Company
 Zions Bank

\$10,000 - \$99,999

Kim & Sally Anderson
 Tim & Paula Barney
 Gary R. & Karen W. Black
 Dr. Vernon M. & Maree C. Buehler
 William Bullen
 George H. "Herb" & Helen A. Champ
 David & Heather Colling
 Scott & Catherine Davis
 Jay & LeeAnn Francis
 Larry & Myra Hendricks
 Roger & Susan Jones
 Jones Simkins
 Lewiston State Bank
 Steve & Tammy Milovich
 William G., Jr., & Billie W. Murray
 Richard L. & Elaine H. Nelson
 Suzanne Pierce-Moore & David Moore
 Clark & Julie Skeen
 Tanner LLC
 Dr. Larry & Laurie Walther

\$9,999 and below

Hassan Mohammed Alshakhs
 Jeffrey G. Bickel
 Dr. Tyler Bowles
 Kent Bracken
 Moline Dastrup
 Ray Ellison

Abdullah Mohammed Faisal
 David Fjeldsted
 Douglas J. Hansen
 Lance Forrest Hendricks
 Robert D. Howell
 Trisha Ann Hunsaker
 Peter Jacobson
 MK Jeppesen
 Spencer James Jeppesen
 Brent Johns
 Scott Thomas Jones
 Glenn Larkin
 Tyson Lucherini
 Andrew K. Millerberg
 Robert B. Murray
 Bruce & Karen Thompson
 Paul Steven Rossiter
 Gary M. Yonamine
 Qinqing Zhu

We want to also acknowledge the vision, passion, contributions, and day-to-day dedication of GSBS Architects, LMN Architects, Saint Dauphin Design, Spindler Construction Company, Utah Division of Facilities Construction & Management, and USU Facilities in the design, planning, and building of an incredibly thoughtful building. We also want to acknowledge our friend Howard Clark for donating the amazing art in Huntsman Hall.



Jon M. Huntsman, noted entrepreneur, philanthropist, and public servant, challenged us in 2007 to build a business school that produces students who can compete with the best and brightest anywhere in the world.

This son of a schoolteacher has devoted significant time and treasure to improving the human condition, including giving to educational causes in his community, to his alma mater the Wharton School, and to Utah State University.

His challenge to us in 2007 has now brought us world-class faculty, incredible new curricular and extracurricular opportunities for our students, and local, national, and global accolades. The opening of the Jon M. Huntsman Hall is another significant step in our journey to create a world-class business program. We are indeed grateful for his vision, his generosity, and his continuing challenge to spur us on to greater heights.

"We cannot say enough about the Huntsman family. We appreciate the great contributions that have been made in so many ways. We cannot overstate the blessing that Utah receives because Jon and Karen Huntsman call Utah home."

— Governor Gary Herbert

PHOTO BY DONNA BARRY

“Thank you to those of you who have helped us make this dream come true. It’s by no means a one family or a one person job. It’s taken the heart and soul of so many of you in this room. Please know that Karen and I share this podium with each of you.”

— Jon M. Huntsman, Sr.



Student Lounge



Dell Loy & Lynnette Hansen Scholars Pavilion (2nd floor pictured)

PHOTOS BY EMILY BEUS, SYLVIA WESTON

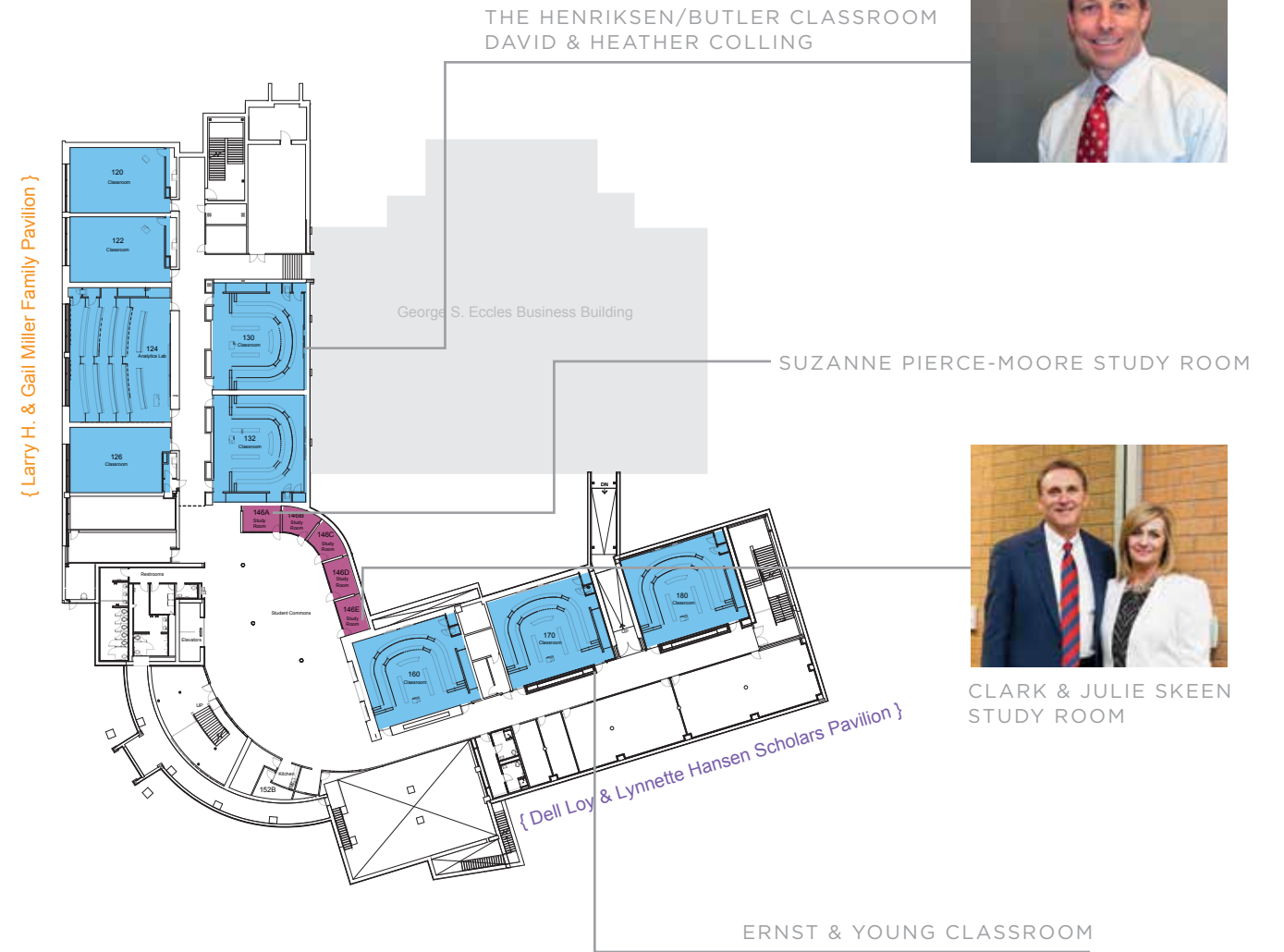

THE HENRIKSEN/BUTLER CLASSROOM
DAVID & HEATHER COLLING



CLARK & JULIE SKEEN
STUDY ROOM

1st Floor

DELL LOY & LYNNETTE HANSEN SCHOLARS PAVILION

Dell Loy & Lynnette Hansen, two proud Aggies, have supported hundreds of students across Cache Valley and at USU through their commitment to education. Huntsman students benefit through the Hansens' generous support for the Hansen Scholars Program and Huntsman Hall.





Kem & Carolyn Gardner Atrium

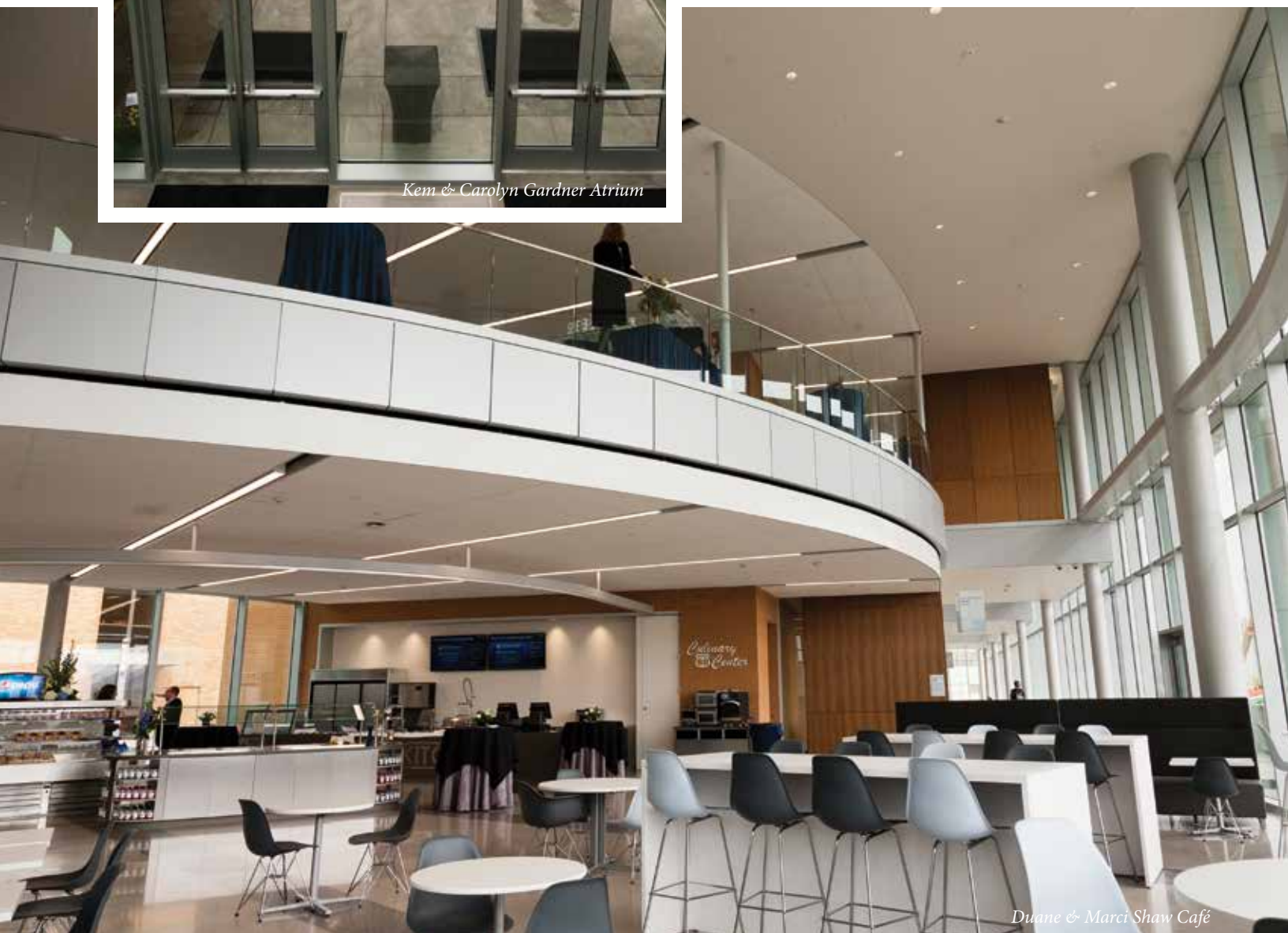

Duane & Marci Shaw Café



KEM & CAROLYN GARDNER ATRIUM



THE MOUNTAIN WEST SMALL BUSINESS FINANCE STUDY ROOM
SCOTT & CATHERINE DAVIS



MARK & JENNIFER ERICKSON CLASSROOM

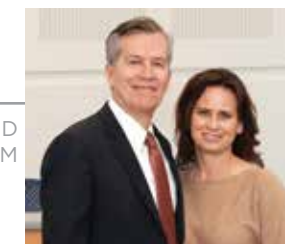

MARK K. & WENDI P. HOLLAND CLASSROOM

PHOTOS BY EMILY BEUS

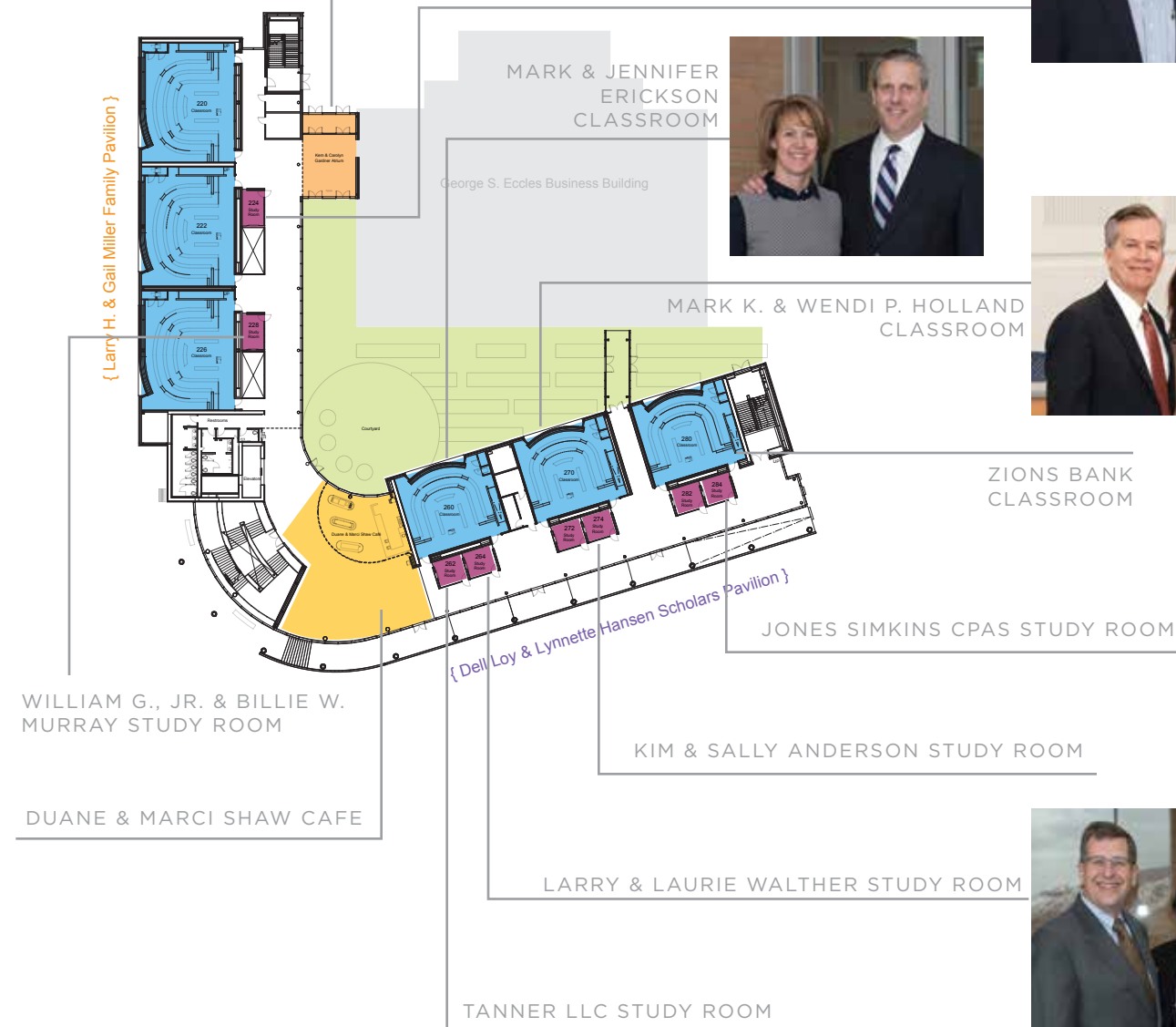

WILLIAM G., JR. & BILLIE W. MURRAY STUDY ROOM

DUANE & MARCI SHAW CAFE

JONES SIMKINS CPAS STUDY ROOM

KIM & SALLY ANDERSON STUDY ROOM

LARRY & LAURIE WALTHER STUDY ROOM

TANNER LLC STUDY ROOM

2nd Floor

DUANE & MARCI SHAW

The café in Huntsman Hall is named Shaw's 88 in honor of Duane & Marci Shaw. Both Aggies, Duane & Marci have supported USU students for many years. Huntsman students have also benefitted through Duane's active engagement in career development and placement of our students.





Student Lounge

Larry H. & Gail Miller Family Pavilion (2nd floor pictured)



PHOTOS BY EMILY BEIUS, CASEY MCFARLAND

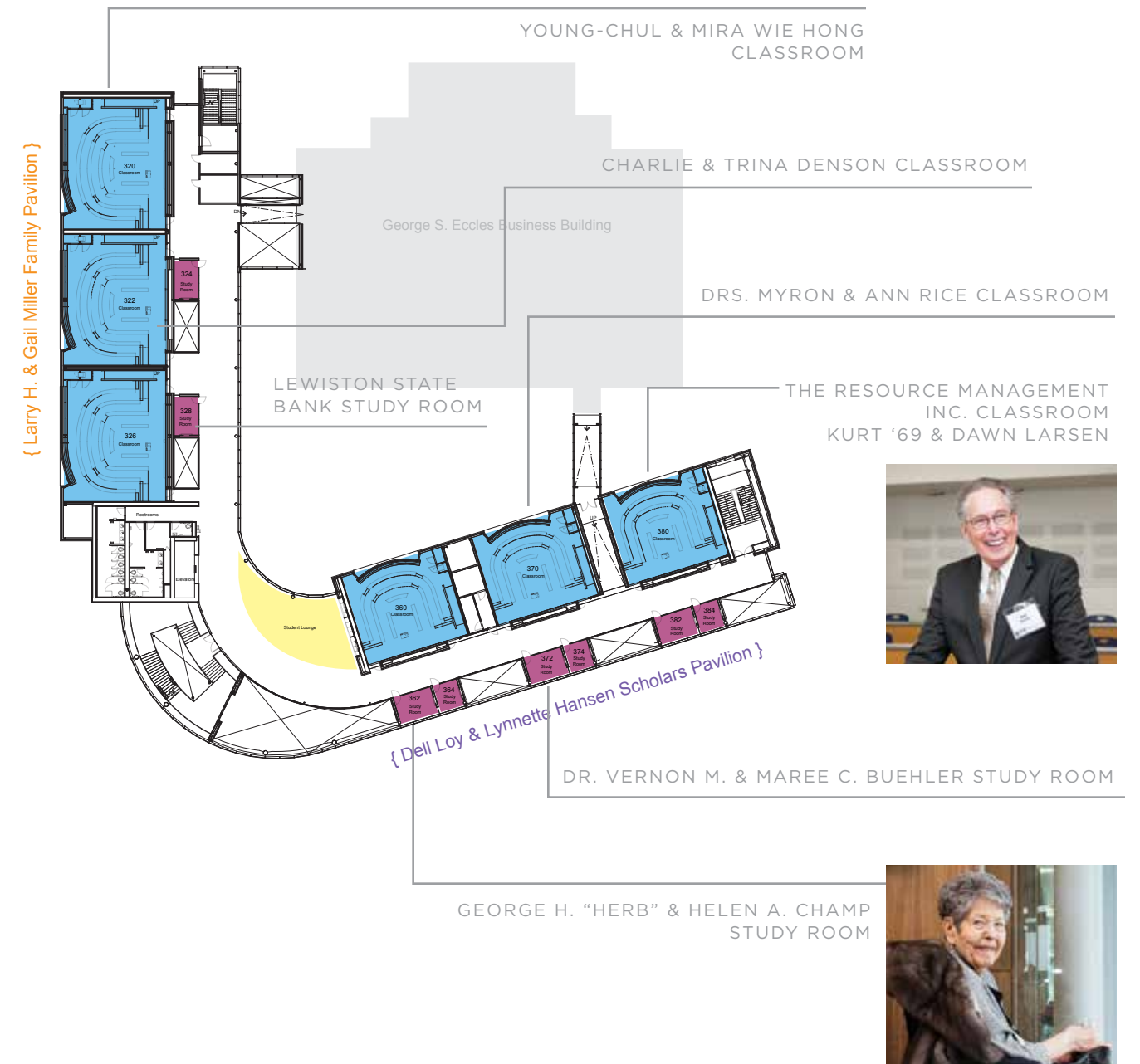

3rd Floor

LARRY H. & GAIL MILLER FAMILY FOUNDATION

Larry H. Miller built a legacy of giving back to the communities where he conducted business. Today, his wish to "Go about doing good until there is too much good in the world" inspires Gail Miller and the Miller family to support their community, including their generous support of Huntsman Hall.

Pictured L to R: Larry H. Miller Group EVP Jay Francis, Jennifer Whitworth, and Larry H. Miller Group President Clark Whitworth





Douglas D. Anderson Executive Boardroom



L. Tom Perry Community Pavilion

PHOTOS BY DONNA BARRY, CASEY MCFARLAND

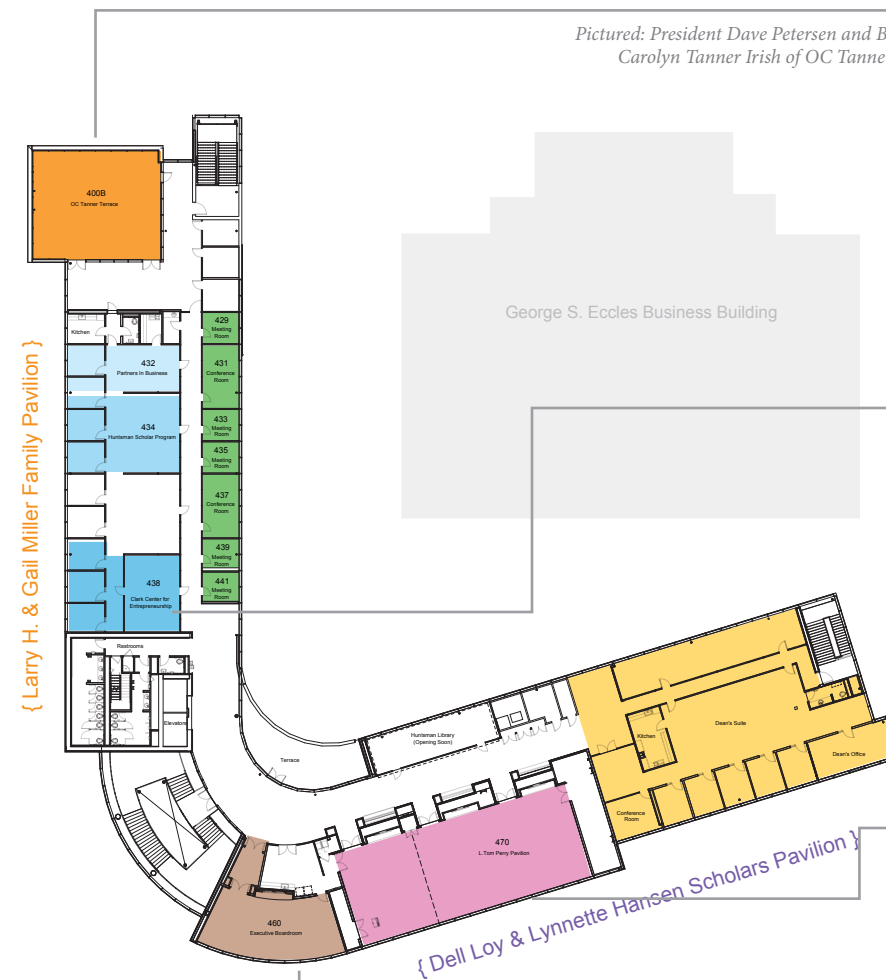

4th Floor

JEFF & BONNIE CLARK

Noted entrepreneur Jeff Clark was instrumental in creating the entrepreneurship program at USU, and as chairman of the capital campaign for Huntsman Hall, exhorted us all to “go big.”

OC TANNER COMPANY

The OC Tanner Company and the Tanner Charitable Trust have supported education across Utah, and their support for Huntsman Hall adds to the decades of support for USU.

L. TOM PERRY COMMUNITY PAVILION

L. Tom Perry was a businessman and religious leader who was a member of the Quorum of the Twelve Apostles of the Church of Jesus Christ of Latter-day Saints. He was born and raised in Logan, and graduated from the Utah State Agricultural College in 1949 with a degree in finance. Elder Perry was honored as the Distinguished Executive Alumnus of the Huntsman School in 2006 and received an honorary doctorate from USU in 2008. To honor this most distinguished Aggie, we designed a large event space, with perhaps the most incredible views of Cache Valley.



OC TANNER TERRACE



JEFFREY D. CLARK CENTER FOR ENTREPRENEURSHIP



L. TOM PERRY COMMUNITY PAVILION



DOUGLAS D. ANDERSON EXECUTIVE BOARDROOM



BUILDING HUNTSMAN

The opening of Huntsman Hall is a significant step in our journey to build a top-tier business education program. The past ten years have witnessed the naming of the College of Business, the creation of 13 curricular and extracurricular programs, the opening of two centers of excellence, rising enrollments in both quality and quantity, recruiting of world-class faculty, and engagement by increasing numbers of corporate partners seeking our best and brightest students.

The Huntsman School of Business is the oldest continuously operating business school west of the Mississippi River, having its origins in 1889 as the

Commercial Department of the Agricultural College of Utah. Our legacy includes renowned academic research that expanded thought leadership across business disciplines, incredible teachers who helped to transform the lives of countless students, and amazing students who went on to phenomenal professional success, including a Nobel Prize in Economics.

Our students are the center of all we do. Those words are reflected through our nationally-ranked accounting program, our 19:1 students-to-faculty ratio, world-class faculty, annual scholarships in excess of \$1 million, 20 award-winning student clubs, consistent accolades from regional, national, and international student competitions, and a 95 percent placement rate.

We are on a journey to create a top-tier business education program. This lofty goal, reflective of our motto to dare mighty things, is possible primarily due to the amazing students who walk through our halls every day. They bring with them a rich heritage of integrity, initiative, and hard work, and together with

dedicated faculty and staff, light the way to a promising future.

While we celebrate the opening of a beautiful new building, our purpose remains to be a career accelerator for our students and an engine of growth for our community, our state, our nation, and the world. Our aim is to bring together our amazing faculty, staff, alumni, and friends to create incredible opportunities for our

“There is a remarkable atmosphere on the campus and the community of Logan. The University has a sense of purpose. There is a remarkable quality of life here. These factors will all combine to help us make this business school one of the finest in the country.”

— Jon M. Huntsman, Sr.

students. That is how we answer Jon Huntsman’s challenge to produce students who can compete with the best anywhere in the world. That is how we are Building Huntsman.

PHOTOS BY DONNA BARRY, EMILY BEUS



LEADERSHIP GIFTS

In recognition of individuals and organizations whose cumulative giving to the Jon M. Huntsman School of Business exceeds \$100,000.

Society of 1888
\$10,000,000 or more
The Huntsman Foundation

Juniper Society
\$1,000,000 – \$10,000,000

Vernon M. Buehler, '41
The Call Family Foundation
Jeffrey D. '82 & Bonnie Clark
George S. & Dolores Doré Eccles Foundation
Kem & Carolyn Gardner
Dell Loy, '82 & Lynnette Hansen, '73 & '75
Young-Chul, '73 & Mira Wie Hong
Charles G. Koch Charitable Foundation
The Larry H. & Gail Miller Family Foundation
James H., '74 & Bonnie B. Quigley, '74
Woodey B. Searle & Vonetta S. Searle Trust
Duane '73 & Marci M. Shaw

Menlo F. Smith
O. C. Tanner Company

Benefactor
\$500,000 – \$1,000,000
IBM Corporation
Oracle Corporation
Mignon Perry, '41 & '47
Zions Bank

Dean's Circle
\$100,000 – \$500,000
Alan, '74 & Kathleen Allred, '72
Gary Anderson, '78
H. Brent & Bonnie J. Beesley
Gary R., '63 & Karen K. Walton Black, '65
Joseph L. & Karen Dunn Black, '58
Boeing Company
Mary, '69 & Mark Bold
Brian, '93 & Natalie Broadbent, '94

Val A. Browning Foundation
William H. & Patricia Child
Harold W., '48 & Ruth B. Dance, '49
Scott G. & Catherine B. Davis
Deloitte Foundation
Charlie, '78 & Trina Denson
Blake E., '96 & Alison B. Dursteler
Eccles First Security Foundation
Mark V. '95 & Jennifer Erickson '94
Ernst & Young Foundation
FJ Management, Inc
Ford Motor Company
Great Plains Software
Larry R., '68 & Myra Hendricks '67
David D., '77 & Loretta S. Hickox
Mark K., '86, '88 & Wendi Holland
Philip Kyupin, '68 & Gemma Yang Hwang, '68
Joseph L., '67 & Diane Keller
Ross E. '60 & Nancy Kendell
Ron K. '83 & Sherrie A. '79 Labrum Trust

Jack D. & Betty Lampros
Kurt L. '69 & Dawn Larsen
Steven, '79 & Tammy, Milovich, Jr.
Robert B., '51, and Beverlee Z. Murray '52
William G. '72 & Billie L. Murray, Jr., '74
Jay H. Price, Jr.
Questar Corporation
Rational Software Corporation
The Sorenson Legacy Foundation
Ann S. & Myron Downes* Rice
Jim K. Sorenson, Jr., '70
Edna Southworth
Harold C., '42 & Grace M. Steed, '46
Donnell B. & Elizabeth D. Stewart
Education Foundation
Kay '69 & Judy Toolson
Workers Compensation Fund
Leah M. Wright, '27
Morris H., '35 & Loree McGee Wright, '37

GIVING JAN2015-MAR2016

TO THE JON M. HUNTSMAN SCHOOL OF BUSINESS

In recognition of individuals and organizations who contributed.

\$500,000 and above
George S. & Dolores Doré Eccles Foundation
Charles G. Koch Charitable Foundation
Larry H. & Gail Miller Family Foundation

\$100,000-\$499,999
H. Brent & Bonnie J. Beesley
The Call Family Foundation
Deloitte Foundation
Blake Evans & Alison B. Dursteler
FJ Management Inc.
Kem C. & Carolyn Gardner
Jon M., Sr. & Karen H. Huntsman
Ann S. Rice
Menlo F. Smith
The Sorenson Legacy Foundation

\$50,000-\$99,999
Brian R. & Natalie I. Broadbent
Vernon M. Buehler
Charlie & Trina Denson
Chairman Young-Chul & Mira Wie Hong

\$10,000-\$49,999
Kim & Sally Anderson
Loila F. Anderson
Gary R. & Karen W. Black
W. Boyd Christensen
David R. & Heather L. Colling
Scott G. & Catherine B. Davis
Eccles First Security Foundation
Mark V. & Jennifer Erickson
Ernst & Young Foundation
Mark O. Haroldsen
Larry R. & Myra Hendricks
Henriksen-Butler Properties
David D. & Loretta S. Hickox
Mark K. & Wendi Paskins
Holland
Craig L. & Lisa Ray Janes
Jones Simkins, LLC.
Ron K. & Sherrie A. Labrum Trust
Kurt L. & Dawn Larsen
Lewiston State Bank
Darren D. Menlove
Steve, Jr. & Tammy K. Milovich
William G., Jr. & Billie L. Murray
Dr. Stephen D. & Christine L. Neeleman
Richard L. & Elaine H. Nelson

Jay H. Price, Jr.
Questar Corporation
James H. & Bonnie B. Quigley
Gregory D. Shuman
Clark P. & Julie J. Skeen
Jim Sorenson, Jr.
Ross D. & JoAnn Stokes
The Walt Disney Company Foundation
Kay & Judy Toolson
Kent F. & Jolyn Ure

\$5,000-\$9,999
AIM Utah
Bank of Utah
Haven J. Barlow
Timothy & Paula Ann Barney
K. Boyd Baugh
Bill & Margaret M. Bullen
Helen A. Champ
Chevron Corporation
Ray Ellison
Kennecott Utah Copper, LLC
David C. & Ilene Lewis
Corey B. & Janis Lindley
Scott & Shiree Nixon
Dennis A. & Julie A. Parker
Wells Fargo Educational Matching Gift Program
Clark L. & Jennifer R. Whitworth
Workman Nydegger

\$1,000-\$4,999
Alliant Energy Foundation, Inc.
Curtis & Venice Andersen
Keith D. & Leslie D. Andersen
Gail & Martha Jane Anger
Spencer K. Bailey
Barrick Gold of North America Inc
Brant & Jodi Leigh Bennett
Darren T. & Brigeta Benson
Jeffrey G. Bickel
Chad H. & Catherine Ann Blackham
Bonneville International Corporation/KSL
Eric Lloyd Browning
Jody K. & Dione W. Burnett
C. Gordon Call
D. Chad & Kelli A. Carlson
Tracy Christman
Thomas Wilson & Stephanie M. Colligan
Consolidated Electrical Distributors Inc.

Ryan Jessen & Karen Kellett Dent
Jeffrey T. & Sheryln C. Doyle
Van F., Jr. & Janis Dunn
Energy Management Corporation
Ensignal
Todd V. & Sally S. Erickson
Christopher & Christa A. Fawson

Peter A. & Patricia C. Sadoski
Shopko
Randy T. & Janet Simmons
Larry D. & Joyce Sprouse
Stewart Education Foundation
Sweet Candy Company
O C Tanner Company
Tax Executive Institute, Inc.

Gregory S. & Joni Bassett
Sidney L. Beckstead
Robert J. & Susie Beers
Daniel K. & Marilyn Bell
Cody J. Belnap
Chlodene Bingham
Jason Dale Bingham
Ingrid Blankevoort



The scholarship support I've received meant that I could participate in lots of programs and activities outside of the classroom. As I prepare to graduate, I've found that the leadership experiences I gained by participating in student government are the differentiator in my job interviews. Without scholarships, I could not have done that. Thank you so much for your support.

Steve Wilcox, Marketing, '16

Russell F. & Barbara Fjeldsted
Ted Forbes
Cecelia H. Foxley
E. Vance & Tamara Grange
Russell K. Grant
Douglas J. & Toni K. Hansen
Gary B. & Helen U. Hansen
Christine M. & Kevin G. Hasler
Marcus L. & Martha Ann Hunt
Lynn E. & Irma Janes
Kenneth D. Jeppesen
Paul D. & Jan Judd
Joseph L. & Diane Keller
Ross E. & Nancy M. Kendall
KeyBank Foundation
KPMG Foundation
Jack D. & Betty J. Lampros
Glenn N. & Karen Larkin
Roger T. Lee
Cris Lewis
Gene W. & Ruth E. Miller
Scott D. & Carol A. Nelson
Northwest Cosmetic Labs
Tyler R. & Marce E. Olsen
Sheldon L. & Angela Peck
Paul E. & Lisa R. Quinn
Dwight Reilly
Kenneth J. Rose
Paul Steven & Mariko Rossiter
Dan C. & Manon C. Russell

The Richard M. Schulze Family Foundation
Jason J. & Tami R. Van Tassel
Larry Andrew Ward
Dominic A. & Jeanette Welch
Jason Richard & Rebecca R. Wendel
MaryAnn Wright
Wesley J. & Cori A. Yeomans
Young Automotive Group
Nicholas N. & Amy G. Zollinger

\$100-\$999
Jeffrey A. Abplanalp
Nate & Laurel Cannon Alder
Michael D. Allen
Roy V. & Judith Allen
Marty L. & Melanie B. Allsop
Paul E. & Rachel L. Amidon
R. Curtis Anderson
Gregory A. Andruk
Brian J. & Jill R. Andrus
Jill Heather Aoki
Andrew J. Arveseth
Brady P. & Lisa S. Bagley
Ryan Griffin Baldwin
Randall I. Bambrough
Greg D. & Cindy P. Bangerter
Daniel D. & Stephanie Barello
Dean E. & Lyn R. Barker
Jennifer Evans & Ted B. Barratt

Tami Murdock & Robert H. Blotter
Robert D. Bond
Wendy Bosshardt
George Bower
Tyler J. & Marni G. Bowles
Kent E. Bracken
Maria J. Bradley
William W. Brinton
Robert L. Brown & Sandra Thorne-Brown
Arlene Burgener
Mark D. & Bryndie M. Burton
Spencer D. Butterfield
Clifford V. Buxton
Garry Dee Bybee
Shelley Ann Bywater
Randall & Paula K. Call
Campbell Scientific, Inc.
James W. Chadburn
Amy A. Chanthalyxay
Chemical Methods Associates, Inc.
Shiann-Jang & Jin-ly Y. Chern
Gene Arthur & Laree Chiodo
Anthony C. D. Choi
Leo D. Christensen
Soren K. Christensen
Camille Christiansen
Kerry A. Christiansen
Cody W. & Stephanie K. Clement



PHOTOS BY CASEY MCFARLAND

Brian S. Coffman
ConocoPhillips Company
Rod F. & Jenny B. Cook
Ward Anthony Coombs
Don R. Cowley
Benjamin J. Croshaw
Danielle Crosland-Nielson
Denzel F. & Joan Datwyler
Dusty D. & Tonya R. Davis

R. Michael & Janice Elich Histon
Brady B. Hoggan
Daniel Vance Holland
Loy A. Holt
Nathan S. & Rachel Holyoak
Winnie W. Hou
Eileen Huber
Brian Michael-John Huculak
Gorden L. Hughes

Jonathan M. Liechty
Paul M. & Edell Lindley
Scott Lindsay
Janet P. & Randy Lint
Jonathan T. Linville
Brandon B. & Carson B. Lish
Kirirath Mam
Kevin R. & Erin Mann
Wesley C. Marler

Wallace P. & Pauline C. Murdoch
Robert B. & Beverlee Z. Murray
Newfield Exploration Company
Bonnie B. Newman
Jay C. & Peggy Niederhauser
Jack Nixon, Jr.
Patrick J. Norris
Clifford D. Olsen
John A. Olsen
Michael P. Olson
Gregory Lane & Kari Osterhout
Paul H. Oto
Fred G. & Margaret D. Palmer
Johnny & Jill A. Pappas
Hong Y. Park
J. Marie Pehrson
Don R. & Carolyn Petersen
Ryan M. Petersen
Gregory A. Peterson
Jacob William & Kristina Peterson
Karlie Jo Philpott
Jeffrey Dean & Marilyn Poulsen
Katherine M. Chudoba & Dave
Powelson
Virgil R. & Marie Monsen Pugsley
QEP Resources, Inc.
Kristin & Nick R. Radulovich
Scott A. & Lindsay A. Ramage
Eric W. & Michelle Rasmussen
Veronica Read
Matthew E. & Sarah Jane Regen
Retirement Plan Solutions
Administrators
Doraleen Rich
Todd W. & Karrie Rich
Stephen Ray Richards
Alan D. & Tammy Rindlisbacher
Clifford A. & Suzanne Smece
Rockstead
Kenneth W. Rodgers, Jr.

Roll Top, Inc.
Brian G. & Leeann W. Russell
Ryan, LLC
Lois P. Salisbury
Brent S. & Allyson K. Sandberg
Kent A. & Diana Kae Sargent
Rick S. Satterfield
Robert David Scharman
Hannes Schenk
Tate D. Secrist
Craig & Guyenne Sellers
Dennis L. & Lynn Sessions
Fred L. Shaffer
Mallikarjun B. Shintri
Patrick Shuldberg
Helen L. Simmons
Stephen A. Simmons
Hoyt Jon & Carmen C. Skabelund
David L. Smith
Doyle John & Ona Marie Billings
Snow
Lynn & Janet K. Snow
Don L. Sorensen
Kevin Soria
Iris W. Sparks
Jerry R. Springer
Richard A. & Kathy Jane Stachon
Star Point Enterprises
Brent Phillip Stewart
Mark Robert & LeAnn Stoddard
Lynn J. & Ruth Marie Stoker
Strong & Hanni PC
Kevin B. & Tracy T. Suminguit
Clay & Stacy Bullen Swain
J. Danny Tasker
Brad T. & Dianna Lee Taylor
Ward & Lynette Taylor
The McGraw-Hill Companies
Lane L. & Annette Thomas

Louise R. Thomas
Ralph S. Thomas
Theo & Arla Dene Thomson
Ronald Chester & Louise L.
Tolman
Jason J. & Becky S. Tomlinson
Travelers
Harlan C. VanOver
Bonnie B. & Oscar Villarreal
Walter Bryan Voisard
Gary D. Walker
John Chung Wang
Rachel & Douglas J. Ward
Darwin J. Weeks
Walter D. Welti
N. C. Whitehouse
Lacey L. Wilkey
Andy Williams
Cardon W. Willis
Thomas & Deborah Lynn Willis
Brian L. & DeLee Winegar
Gary M. & Pamela T. Yonamine
Carson W. Young
Robert S. Young

Thomas J. Campbell
Cynthia Carter
Brian & Jacqueline A. Chambers
Darwin & Judith Christensen
Samuel Spencer Christensen
Dorilee & Wayne Clegg
Alex J. Colby
Sloan Collins
David Cruz
Weston E. Curtis & Micah T.
Smith
Taylor B. Dance
Bret I. Dayley & Shayleen
Michelle Crank
Kathryn J. Delorey
Loren G. & Judith A. DeMond
Jacob Dean Dettinger
Austin Dale Dickson
Marianne J. D'Onofrio
Lynn W. Edwards
Matt Egnew
Bert K. & Wendy Lyn El-Bakri
Christopher N. Elliott
Ryan B. & Whitney L. Ennis
Izaak T. Erekson
Jeffrey Richard & Cristian C.
Erickson
Lester Kimball & Shauna Lyn
Essig
Bezhan Morteza & Kathryn
Fargam
Brandon J. Foote
Michael Gagon
Doug & Linda Hadfield Garrett
Ronald P. Garrett
Tyler A. & Anna M. Gillespie
Kay La Vaune & Joan Gneiting
Lyndsie Gourley
Kent & Jan Greene
Mark C. Groberg
Kathryn Kristine Grover
Barbara Gutke
Gilbert Leonard & Beth Lorraine
Haggen
Brian G. Hall
Rustin Ray & MaryAnne Hansen
Jordan M. Harman
Julie King & Joel Harris
Laura Harvell
Lance Forrest Hendricks
Jeffrey J. Hibbs
Steven & Melissa O. Hills
Drue W. & Lisa L. Hokanson
Adam C. & Christine M. Holt
Dale C. & Linda K. Huffaker
Larry W. & Marie E. Humpherys
Trisha Ann Hunsaker
Robert T. Hunting
Steven Walker & Karen D. Hurd
Char Izatt
Patricia L. Jackson
Jason R. Jacobs
Earl R., Jr. & Mary Ann Jensen
Brent N. Jensen

Matthew S. & Raelyn M. Jensen
Spencer James & Cassandra
Marie Jeppsen
Justin C. & Jessy Johansen
Kyle K. & Brandee L. Johnson
Eric C. & Candice Johnson
Leona Joyce Johnson
Norman L. Johnson
Dolores M. Keller
Troy J. & Janice Nielsen Killian
Steven G. & Catherine Barlow
Kindred
Kenneth Viking Knebel, Jr.
Louis C. & Camille Koberstein
Riley L. Larsen
Cory L. & Kimberly Anne Larson
Adam Lattin
Thad K. & Emily L. Lemon
I-Rong Lin
Erik T. & Julie Lindstrom

Lance B. & Luann Dobson
Mortensen
Shelby Mckell Murray
Megan Myers
V. Scott Myers
Conrad & Lorie Anne Naegle
Darla Neeley
Alex P. Nelson
Brandon C. & Kathryn A. Nelson
James Neve
Eric David & Stacey P. Noble
Gilbert C. Olsen
Madeline Olsen
Alicia S. Pack
R. Blair Painter
G. Lee Parks
Ana Teresa Patino
Kenneth F. Payne
David S. Peaden
Kevin Scott Peaden

Dan J. Scrivner
Amber Lynne Shaffer
Ashley Simmons
Jaren K. Simper
Thomas R. & Judy Lynne Simper
Janice & Clifford R. Skousen
Lisa M. & John Skriner
Hyrum L. & Melissa L. Smith
Michael & Ann Spilker
Ron & Jeanette B. Squires
John W.* & Carol T. Steinitz
Jason Jeffrey Steinmann
Gary M. & Julie Jensen Stevens
Katy Elaine Stowell
Talon C. Stringham
Joshua Linton Taylor
Guadalupe Tellez
Ann Marie Thompson
Angela L. Thomson
Braden Thurston



The scholarship support I received gave me the opportunity to participate in a study abroad program, and that experience completely changed the way I view our world. I would never have been able to see how business and cultures operate outside of the US without this support. Thank you so much.

Ruby Parkin, Marketing, '18

Mike Day
Jamie Lynn Dodge
Richard M. & Suzy C. Dooley
Brian A. & Natalie H. Earl
Don L. Earl
James N. & Tamara S. Elwood
Enterprise Holdings Foundation
EQT Corporation
EQT Foundation
Steven Espinoza
Chad H. & Sarah E. Evans
Abdullah Mohammad Faisal
Frank A. Fath
Kurtis G. Forsgren
Herbert H. & Rosemary R.
Fullerton
Cara H. Galleni
Jordan W. Garner
Kathy L. Garner
GE Foundation
David S. & Ann T. Geary
Arlo Gilbert
Google
Riki P. & Erin Brynn Graybill
Matthew Alan & Deborah Jensen
Grizzell
Dawson B. Hale
George E. Hall
Donald S. & Jeri Kaye Hamilton
Jo Lynn Hansen
Thomas J. Harding
Ruth Checketts Harrison
Bonnie G. & Douglas B. Hart
Steven J. & Cherri H. Hart
Harold C. Henderson
Lynn W. & Colleen Heninger
Peggy N. Henrie
Craig D. & Christine Hepworth
Abel F. Herrera
Douglas H. & Elizabeth A. Hinkle

Carl L. Hulet
Donald L. Hulet
Kimball Ray Humphrey
Burns & Brenda Israelsen
Alan D. & Linda James
Thomas William & Tracy Lynn
James
Bryant W. & Alexis Jensen
Heather B. & Darrell Jensen
George Jensen
John R. & Donna M. Jensen
Kent S. & Bonnie Jensen
Richard L. & Carol D. Jensen
M. K. & Ellen Rae Jeppesen
Jay J. Joh
Brent R. & Kara L. Johns
Ronald N. Johnson
Wally J. & Harriet Johnson
Christopher Gil Jones
Jason R. & Lesley A. Jones
Jamie Kartchner
Beverly Kastens
John E. & Linda Keith
O. Gary Kelley
John E. & Susan L. Kertesz
Kent Tyler Killpack & Carli
Campbell
Alyson Kirkham
Tyler R. & Cristina Kirkham
Charles Klamm
Tad Arden & Donna Koch
Todd W. Labrum
Robert M. Lamkin, Jr.
Gaylyn Larsen
Robert T. & Karen E. Larson
Carl F. & Jacque A. Lawson
Pearl C. Lee
Clare & Cathy Leishman
Cade M. Lewis
Teresa Douglas & Bret Lewis

Burton W. & Stephanie K. May
Robert Mayo
James B. & Kathleen McDonald
Danette Munk Taggart McGilvray
Aleen & Daniel McGuire
James A. & Rosa McNamara
Brent A. Meacham
David V. Meadows
Bryan Nolan & Michele Mecham
Theodore J. Meyers*
Micron Technology Foundation,
Inc.
Corey R. & Michelle Wecker Miles
Graham Miller, II
Harry L. Miller, Jr.
Tracy Janes Miller



Paintings by artist Howard S. Clark

\$99 and under

Lael J. & Pauline L. Abbott
Kyle D. & Lindsey M. Abplanalp
Aetna Foundation
Jesse D. & Heather Allen
Alliant Techsystems Community
Investment Fndt
Stephen Gary & Carlie Rae Allred
American Express Foundation
Rex W. Anderson
Shaun Alan & Rebecca Anderson
Brett David Andrews
Conna A. Andrews
Jeremy R. & Natalie Z. Andrews
Thomas L. Arnett
Steven K. Atkinson
BAE Systems Inc
Grant H. Baer
Sean Glenn Bailey
William & Jill Bainbridge
Jason B. Baker
Nicholas & Adele P. Ballam
Jacob Leon Bartholomew
David W. & Linda Baugh
Frederick O. Benson
Ace M. & Sasha N. Beorchia
Donald D. Bergh & Julianne
Berch
Jodie M. Boley
J.D. Borg
Christian Summersett Brinton
J. Curtis & Marilyn P. Broadbent
Kenneth H. & Deanna B. Brown
Richard L. Burbidge
Brent Raymond & Kristine Burge
Russell L. Burraston
Cody B. Calder
Campbell Soup Foundation

Thomas J. Campbell
Cynthia Carter
Brian & Jacqueline A. Chambers
Darwin & Judith Christensen
Samuel Spencer Christensen
Dorilee & Wayne Clegg
Alex J. Colby
Sloan Collins
David Cruz
Weston E. Curtis & Micah T.
Smith
Taylor B. Dance
Bret I. Dayley & Shayleen
Michelle Crank
Kathryn J. Delorey
Loren G. & Judith A. DeMond
Jacob Dean Dettinger
Austin Dale Dickson
Marianne J. D'Onofrio
Lynn W. Edwards
Matt Egnew
Bert K. & Wendy Lyn El-Bakri
Christopher N. Elliott
Ryan B. & Whitney L. Ennis
Izaak T. Erekson
Jeffrey Richard & Cristian C.
Erickson
Lester Kimball & Shauna Lyn
Essig
Bezhan Morteza & Kathryn
Fargam
Brandon J. Foote
Michael Gagon
Doug & Linda Hadfield Garrett
Ronald P. Garrett
Tyler A. & Anna M. Gillespie
Kay La Vaune & Joan Gneiting
Lyndsie Gourley
Kent & Jan Greene
Mark C. Groberg
Kathryn Kristine Grover
Barbara Gutke
Gilbert Leonard & Beth Lorraine
Haggen
Brian G. Hall
Rustin Ray & MaryAnne Hansen
Jordan M. Harman
Julie King & Joel Harris
Laura Harvell
Lance Forrest Hendricks
Jeffrey J. Hibbs
Steven & Melissa O. Hills
Drue W. & Lisa L. Hokanson
Adam C. & Christine M. Holt
Dale C. & Linda K. Huffaker
Larry W. & Marie E. Humpherys
Trisha Ann Hunsaker
Robert T. Hunting
Steven Walker & Karen D. Hurd
Char Izatt
Patricia L. Jackson
Jason R. Jacobs
Earl R., Jr. & Mary Ann Jensen
Brent N. Jensen



Thank you so much for all you do. Your continuing involvement with the Huntsman School helps to create and expand opportunities for our students. Your support means we are able to recruit and keep better students, recruit and keep better faculty, and build an incredible facility for our entire Huntsman community.

**Dave Patel
Associate Dean**

Richard A. & Brooke N. Linton
Adam Michael Little
Jacob Little
Jordan B. Livingston
Nate & Dani Lloyd
Tyson J. & Jessica L. Lucherini
Trevor S. & Jessica Garrett Lund
Brenton K. & Erika L. Lusk
Nolan F. & Marian Mangelson
Eric T. Marnell
Lucretia Wilson Mattson
Dallin O. Maxfield
Zach J. Maxfield
James B. McCormick
Cache Mckinley
Doreen J. McLaughlin
Michael David McLeskey
Robert E. Miller
Andrew K. Millerberg & Taylor
Hyatt
Mike Mitchell
Elaine Ann Monson
Alden T. Moon
T. J. & Charity L. Moore
Sterling R. & Kendra Morris
Alex John Mortensen

Scott T. Peiffer
Neil C. & Andrea Perkes
Amy J. Petersen
Tiera Ann Peterson
Shirley Ann Polejewski
Mark Eldon Poole
Wendy K. Poppleton
Mildred Porter
Mary E. & Sage Johnson Price
Stephanie J. Prows
Jeff A. & Sherrie L. Rees
Aaron Balthaser & JaNell J.
Rentschler
Michael Lyman & Emily Michelle
Rich
Wayne S. Robbins
Marion D. & DeeAnne C.
Robinson
Richard Roth
Mark Allen Schroeter

Robert M. & Rae Ann R. Tibbs
Keith & Shaunla Sue Todd
Seth Harris Traveller
Jason & Pauline R. Tubbs
Brandon Adam Tuft
UBS Financial Services, Inc.
Liz & Kelly Veibell
Mike W. Waggoner, Jr.
Collin Allen Wailes
S. S. Walker, Jr.
Brent K. & Sue Smith Wamsley
Dannaey Lyn Ward
Stephen G. & Elizabeth Irene
Watson
Robert D. & Balinda Whetstone
Bryson B. & Kristy D. White
Thomas L. & Corinne Williams
Russell V. & Carol Withers
Gregory V. Wootton
Lawrence Edward Yancey, III
Marvin C. Zepf



Your help is needed to fulfill the vision. Visit huntsman.usu.edu/giving to contribute to the Jon M. Huntsman School of Business.



How I'm BUILDING HUNTSMAN

Mark Erickson, '95 Partner, Tanner LLC; Chairman, Huntsman School National Advisory Board

I grew up in Cache Valley, went to Sky View High School before enrolling at Utah State, married a girl from Logan, and two of our daughters are currently at USU, so I bleed Aggie Blue. My time at USU was everything that I could have wished for, from the academic opportunities to the amazing student life on campus.

My wife Jennifer and I have stayed involved with USU because we gained so much from our time at school. Each year, we host an Aggie Ice Cream social at our home, bringing together USU alumni from the area. It's a great way to see old friends, and to help recruit new Aggies.

I have served on the board of the School of Accountancy and currently serve as the chair of the National Advisory Board of the Huntsman School of

Business. My time serving on these boards has provided wonderful opportunities to interact with faculty and staff, and to engage firsthand with the amazing students at USU. My firm, Tanner LLC, has also benefitted tremendously from involvement with USU, and we have gained a number of incredible employees from our recruiting in Logan.

I'm Building Huntsman because I believe in the power of education to change lives, because I believe USU provides great opportunities for anyone willing to work hard, and because of what USU did for me. I encourage all of you to get involved. Find ways to help the next generation of students. Visit campus, speak in classes, mentor a student, recruit. You might also want to encourage high schoolers in your neighborhoods to look at USU.

Every one of us has the power to help Build Huntsman and propel us forward in our journey to the top-tier. It's as simple as:

- ▶ Coming to campus
- ▶ Speaking in a class
- ▶ Mentoring students
- ▶ Hiring our students
- ▶ Making a gift

Visit huntsman.usu.edu to get involved and help Build Huntsman for the next generation of Aggies.

Office of the Dean
3500 Old Main Hill
Logan, UT 84322-3500

"Academics are of little value unless blended with the more human values of charity, integrity, honor and fairness. Thus, it will always be my hope that the students who enter Huntsman Hall will be engendered with a positive sense of upliftment, enlightenment, edification, honor and charity."

— Jon M. Huntsman, Sr.



USU Huntsman
JON M. HUNTSMAN SCHOOL OF BUSINESS